

10 Stacked Dimensions

Now that we have created a few simple single dimensions, let's continue with the series of vertical distance dimensions on the left side of the drawing. In the past these stacked dimensions were created on an individual basis and then positioned / aligned in the drawing using a point grid ([POINT+GRID](#)).

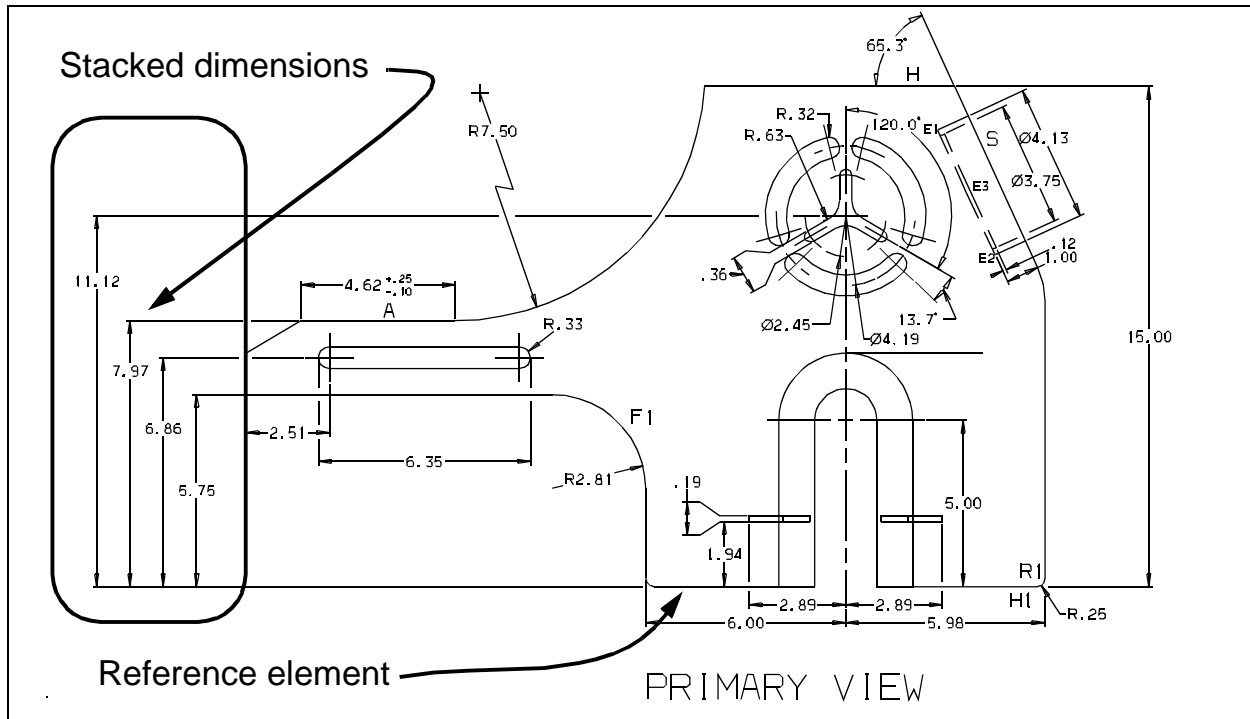

Unfortunately, the lowest extension line was repeated, and the extras had to be removed as necessary. Also, if a dimension was forgotten or one in the series was no longer needed, you had to manually realign everything.



Enter the stacked dimension option. This button along with the [|SPA 1.000|](#) field automatically keeps the series of dimensions relatively spaced and when dimensions are added or removed from the dimension system, the remaining dimensions automatically realign. Let's see how this works.

The 11.12 dimension value is added to the series. Follow this up with our last selection:

```
{ SEL DIMN/SYS_DIM // SEL VAL/TXT }
{ SEL> ELEM // IND DIM_POS // YES:END }
```

Select the top edge of the left flange line "A". The 7.97 dimension is inserted between the two previous dimensions.

As each dimension is added, the initial dimension's position does not change. All other dimensions shift around this location. You may reposition the entire series of dimensions by indicating a new location at any time during the construction sequence. The position of the individual dimension values may also be managed as the dimensions appear, or they may be rearranged at any time during the construction of the series.

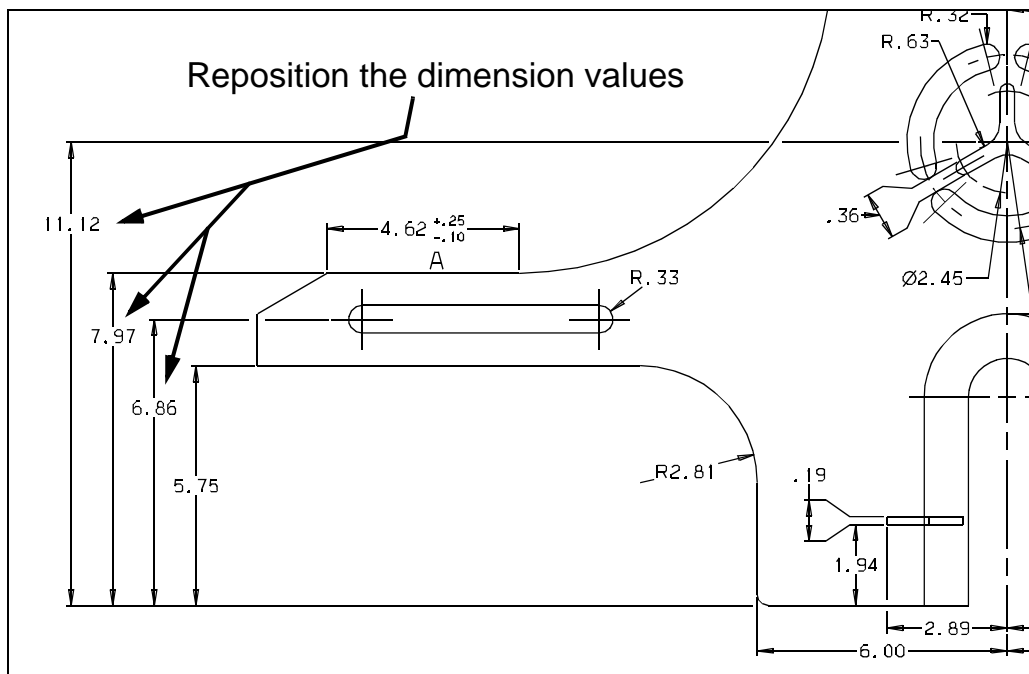

```
{ SEL DIMN/SYS_DIM // SEL VAL/TXT }
{ SEL> ELEM // IND DIM_POS // YES:END }
```

Select the 7.97 dimension value and relocate it along its dimension line by indicating someplace above its original location. See the illustration as a guide.

Repeat this individually for the 6.86 and 11.12 dimension values in whichever order you like and relocate them along their dimension lines. Once you are satisfied, hit **YES** to terminate the creation of the dimension system.